

Building and Grounds Committee

AGENDA

Videoconference

Or

Jefferson County Courthouse
311 S. Center Avenue, Room 205
Jefferson, WI 53549

Wednesday, July 1, 2020
9:00 a.m.

Committee Members

Curtis Backlund, Greg David, Roger Lindl, Laura Payne, Mary Roberts

1. Call to order
2. Roll call
3. Certification of compliance with Open Meetings Law
4. Review of the Agenda
5. Public Comment
(Members of the public who wish to address the committee on specific agenda items must register their request at this time)
6. Communications
7. Approval of the June 3, 2020 Building and Grounds Committee meeting minutes
8. Discussion and possible action on accepting South Campus bids
9. Update from Potter Lawson on courthouse and sheriff facilities schematic design and mechanical systems project
10. Financial Reports (YTD)
 - a. Central Services
 - b. Management Information Systems (MIS)
11. Discuss future meeting schedule. Next scheduled meeting date – August 5, 2020 – 9:00 a.m.
12. Discuss potential agenda items for the Committee's next meeting
13. Adjourn

[Join Zoom Meeting](#)

<https://zoom.us/j/97509662099>

Meeting ID: 975 0966 2099

One tap mobile: +13126266799,,97509662099#

Dial by your location : +1 301 715 8592

A quorum of any Jefferson County Committee, Board, Commission or other body, including the Jefferson County Board of Supervisors, may be present at this meeting.

Individuals requiring special accommodations for attendance at the meeting should contact the County Administrator 24 hours prior to the meeting/visit at 920-674-7101 so appropriate arrangements can be made.

Building and Grounds Committee

(Via Zoom Videoconference and Courthouse, Room 205)

MINUTES

Wednesday, June 3, 2020

1. **Call to Order**
Meeting was called to order by Payne at 9:00 a.m.
2. **Roll Call**
Members Present: Roger Lindl
Members Present via Videoconference: Curtis Backlund, Laura Payne and Mary Roberts
Absent: Greg David
Others Present: Ben Wehmeier, County Administrator; Ron Locast, Potter Lawson; Levi Schubkegel, Potter Lawson ; Kevin Anderson, Potter Lawson; Doug Beilke, Maas Construction; Anthony Maas, Maas Construction; Captain Maze, Chief Parker and Captain Gray.
3. **Certification of compliance with the Open Meetings Law**
Wehmeier reported that the meeting agenda was properly noticed in compliance with the law.
4. **Review of the Agenda**
No changes were made
5. **Public Comment**
None
6. **Communications**
None
7. **Approval of May 6, 2020 Building and Grounds Committee minutes**
Minutes were provided for review.

Motion by Lindl/Roberts to approve the May 6, 2020 Building and Grounds Committee minutes as printed. Motion passed 4-0.
8. **Update from Potter Lawson on courthouse and sheriff facilities schematic design and mechanical systems project**
Locast and Anderson from Potter Lawson gave an update on the project. They have started to lay out the individual spaces and are starting to modify the floor plan based on the feedback they are receiving. They will continue to work with the departments to fine tune the layout. They will then start working with Maas Bros. Construction on an estimating and phasing plan. There are engineers working on the plan for our mechanical systems. This will be discussed at the next meeting. No action taken.
9. **County Project Updates**
Wehmeier said that plans for the south campus are being worked on. There should be bids for the south campus projects ready for review at the next meeting. Staff is also working on recovery planning.
10. **Financial Reports (YTD)**
 - a. Central Services
 - b. Management Information Systems (MIS)

Financial Records were provided for review. No action taken.

11. **Discuss future meeting schedule. Set next meeting date:** July 1, 2020 – 9:00 a.m. via Zoom Videoconference and Courthouse, Room 205.

12. **Discuss potential agenda items for the Committee’s next meeting**
 - a. Approval of Minutes from June 3, 2020
 - b. Update from Potter Lawson
 - c. Review bids for south campus projects

13. **Adjourn.**

Motion by Roberts/Backlund to adjourn at 10:30 a.m.



Meeting Notes

Jefferson County – Courthouse/Sheriff’s Building Design Study

Project No. 2020.01.00

June 3, 2020

Purpose: Building & Grounds Committee meeting to review schematic floor plan layouts.

Location: Zoom meeting

Project Representatives:

Name	Organization	P	ED
Ben Wehmeier	Jefferson Co. Admin.	X	X
Greg David	Bldg. & Grounds		X
Curt Backlund	Bldg. & Grounds	X	X
Laura Payne	Bldg. & Grounds	X	X
Mary Roberts	Bldg. & Grounds	X	X
Roger Lindl	Bldg. & Grounds		X
Tammie Jaeger	Bldg. & Grounds	X	X
Anthony Maas	Maas Brothers	X	X

Name	Organization	P	ED
Doug Beilke	Maas Brothers	X	X
Beth Prochaska	Potter Lawson		X
Ron Locast	Potter Lawson	X	X
Kevin Anderson	Potter Lawson	X	X
Levi Schubkegel	Potter Lawson	X	X
Jared Ramthum	Design Engineers		X
Kelly Harrer	Design Engineers		X

(P=Present ED=Electronically Distributed)

Discussion:

1. Potter Lawson (PLI) gave an update on the study stating that they will continue to meet with and get department layout approvals. PLI will set up additional meetings with Matt Zangl, Zoning and Cindy Hamre Incha, Clerk of Courts/Courts, to review their departments.
2. PLI presented the current schematic floor plans. The Committee had no additional comments for the Courts, Land Use and Administrative departments.
3. Potter Lawson discussed the County Clerk’s concern of not sharing space with Finance. Stating that the clerk’s office depends on some of Finance’s staff to cover the front counter. No decision was made as to whether the two departments should be combined into the same space.
4. Potter Lawson presented three options (Options A-C) for the Sheriff department/Jail. Following are comments from the Building & Grounds Committee:
 - a. Curt B. noticed that the sizes of the spaces for EOC, Emergency Management and Dispatch are smaller in option B than in option A, stating that the space allocations in option A seem more appropriate.
 - b. The EOC and Emergency Management should be in near proximity to each other.
 - c. The Committee stated that the receiving cells are always full and that the number of cells could be doubled and still filled.
 - d. The Committee suggested that the Program space could also be used for exercise and that the proposed Exercise space in Option A could be used as additional receiving cells. Potter Lawson will review.
 - e. Jeff Parker, Chief Deputy, stated that the Jail holds 229 inmates, however the State considers the Jail at capacity at 80% which is approximately 183 inmates. On any given day, there are approximately 190-192 inmates in the facility. The State views the Jail as at capacity.
 - f. There are currently 28 state inmates. The revenue for providing housing for the state inmates is approximately \$750,000.00 per year.
 - g. Jeff P. stated that as the County’s population has grown, the daily population of the Jail has also grown.

- h. The EOC and consolidation of Dispatch is a priority for the master plan.
 - i. Ben W. stated that the master plan should include keeping the Jail on site w/ an option for expansion. Jail expansion is not seen as an immediate need.
5. The Building & Grounds Committee directed Potter Lawson to continue planning based on a hybrid of Option A and B. Option C is to be included in the master plan as a future need for Jail expansion.
 6. Once the floor plan gets more established, PLI will contact the District Judge for review of the courts.
 7. Design Engineers will present at the next Building & Grounds Committee meeting. They will give an update on the existing systems and how the mechanical systems may impact construction phasing.

Issues Requiring Resolution:

Action by:	Issue:
Potter Lawson	Schedule meetings with departments for layout review/approvals.
Potter Lawson	Study Program space to also be used as exercise space.
Potter Lawson	Develop the Jail plans based on a hybrid of Option A & B.
Potter Lawson	Contact the District Judge to review the plans once they're developed further.
Design Engineers	Present at the July 1 Building & Grounds Committee meeting.

Next Meeting: July 1, 2020 @ 9:00 am

The above constitutes items discussed and decisions reached. If there are any additions and/or comments, please contact the undersigned.

Sincerely,



Ron Locast
Project Manager

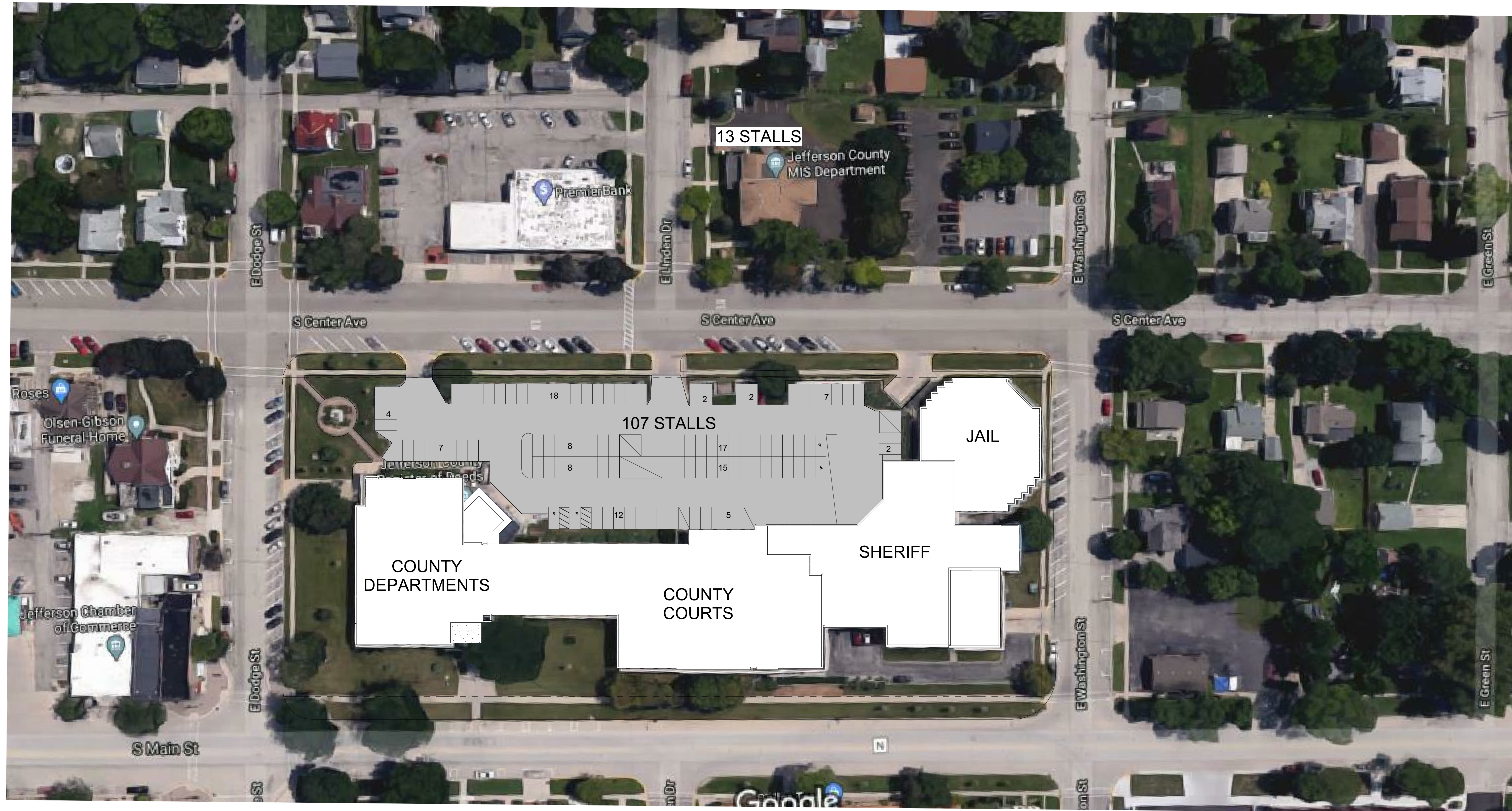

Existing Site Plan
 Jefferson County - Preliminary Design Study
 03 JUN 2020

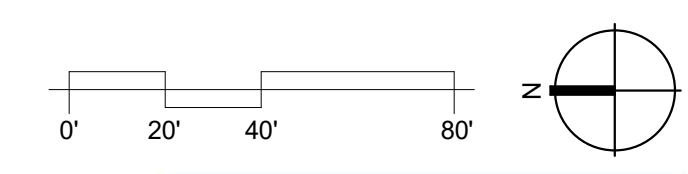

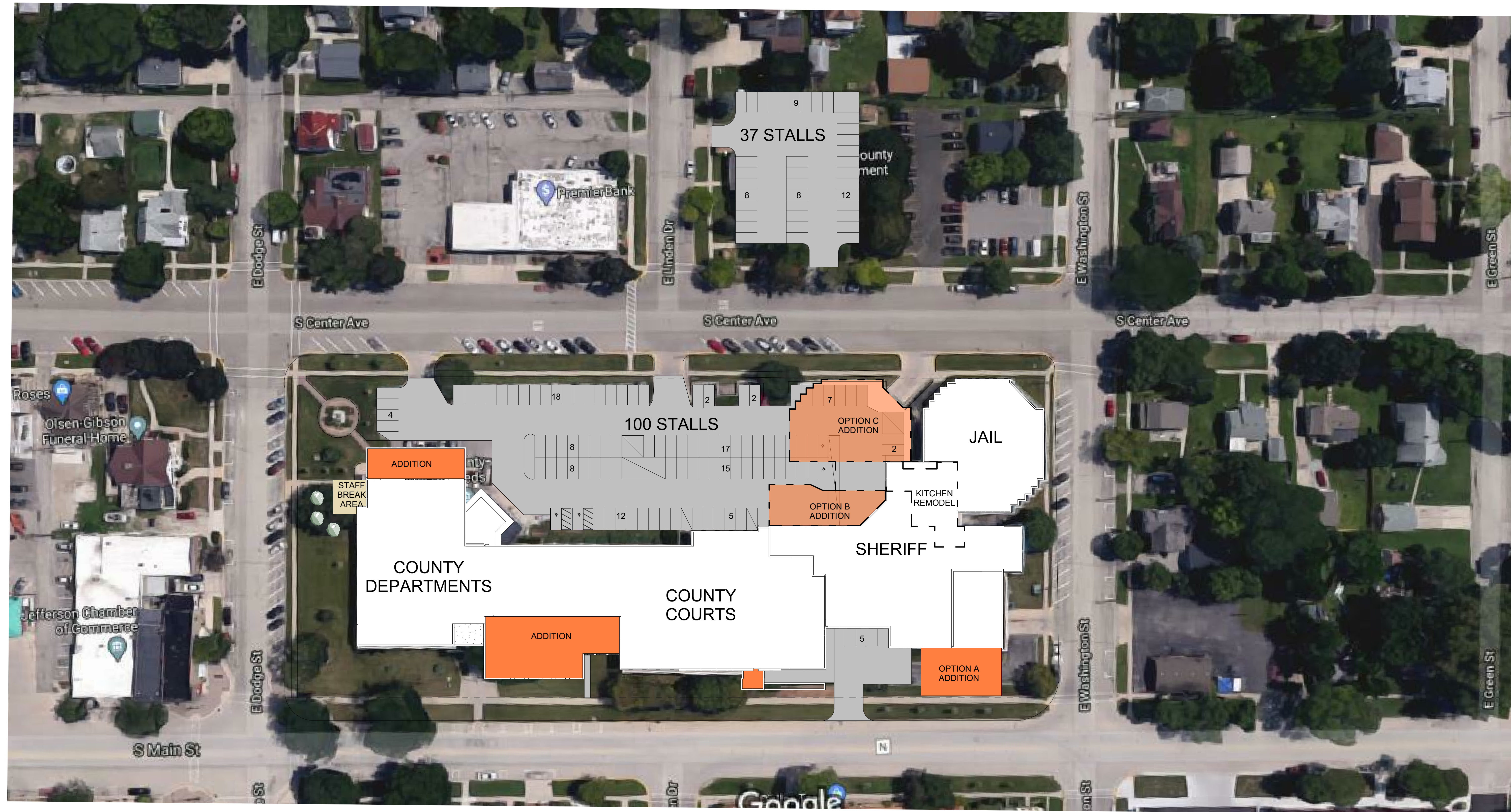

Site Plan
 Jefferson County - Preliminary Design Study
 03 JUN 2020

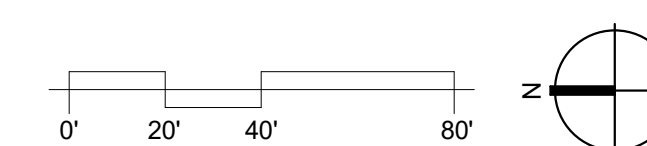

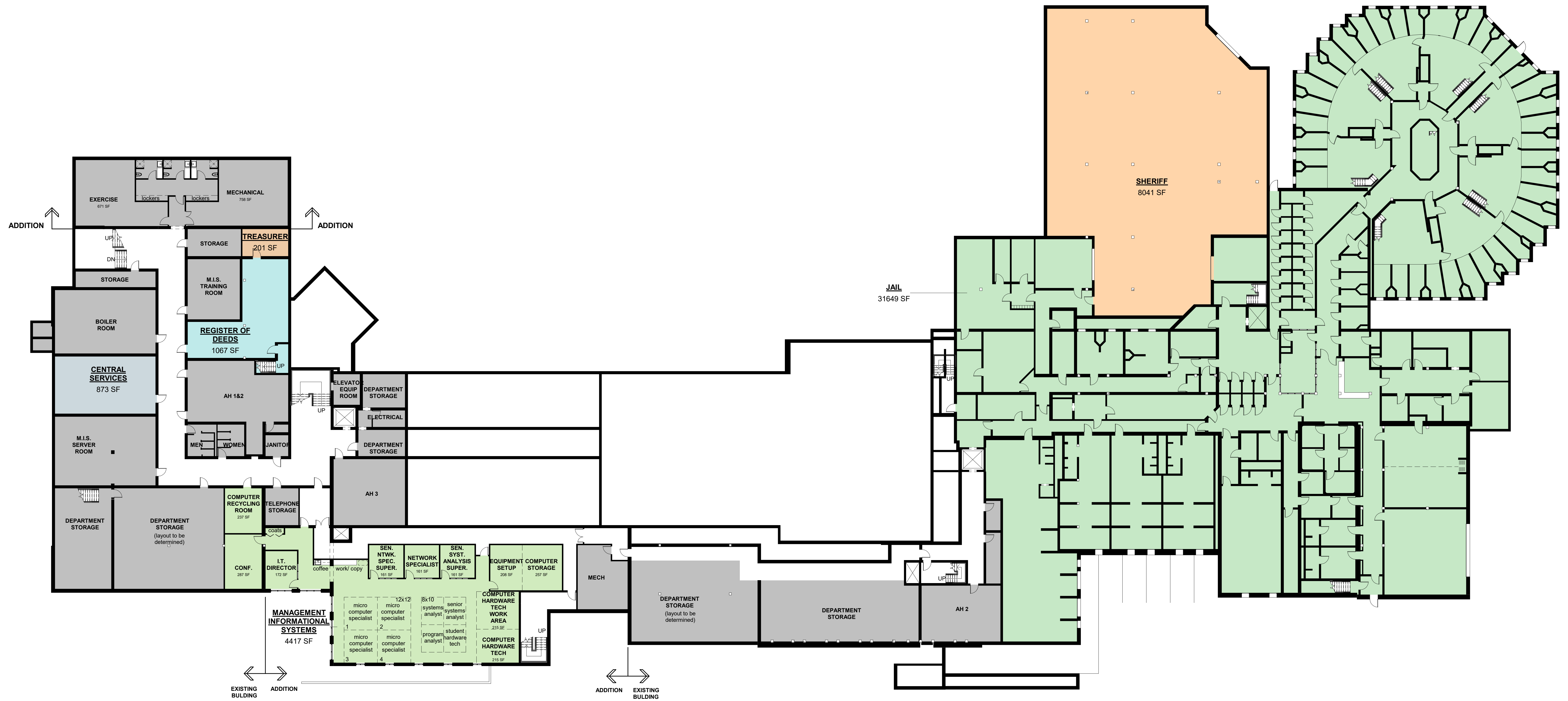

Ground Floor Plan
 Jefferson County - Preliminary Design Study
 03 JUN 2020

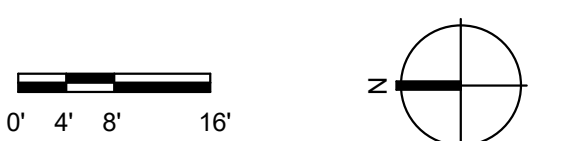

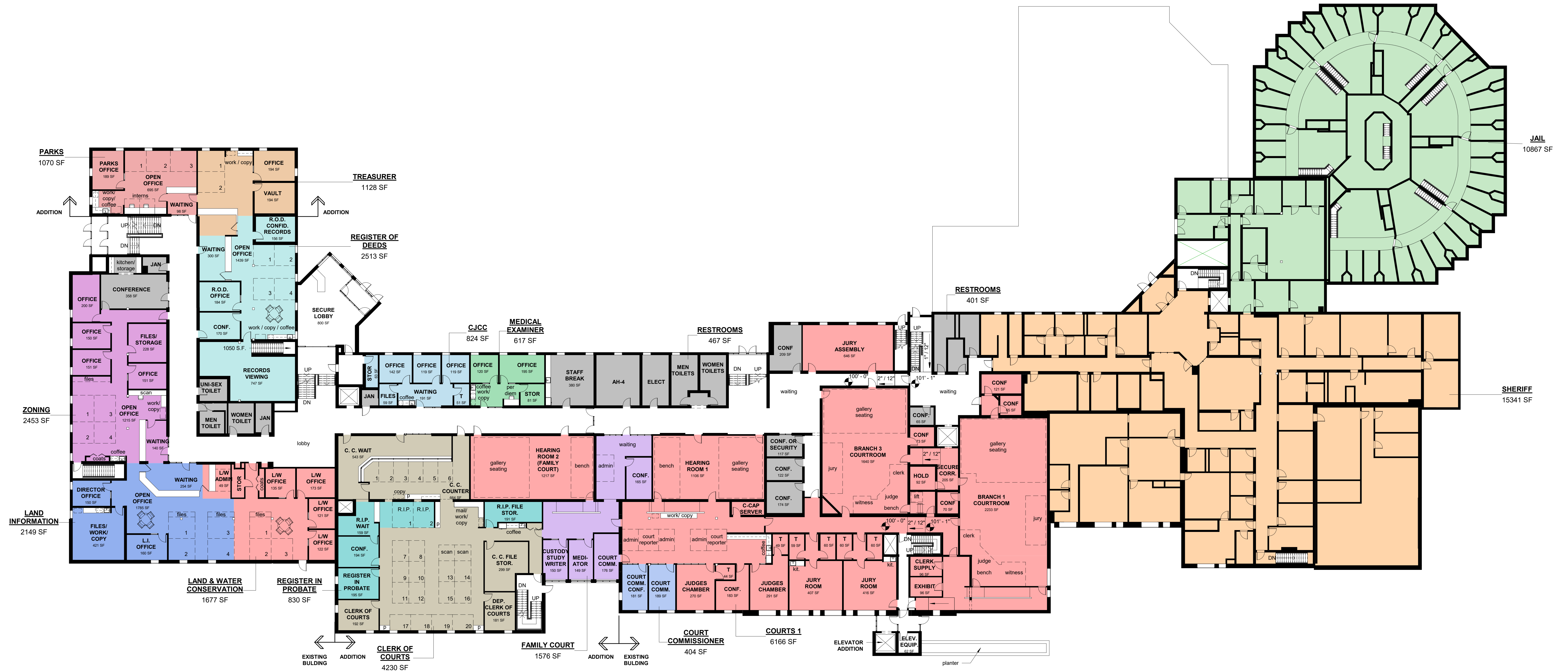

First Floor Plan
 Jefferson County - Preliminary Design Study
 03 JUN 2020





Second Floor Plan
 Jefferson County - Preliminary Design Study
 03 JUN 2020

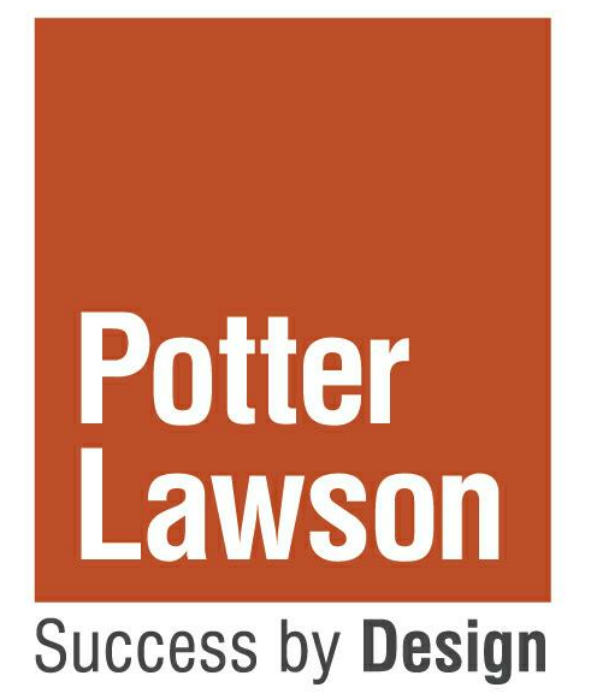

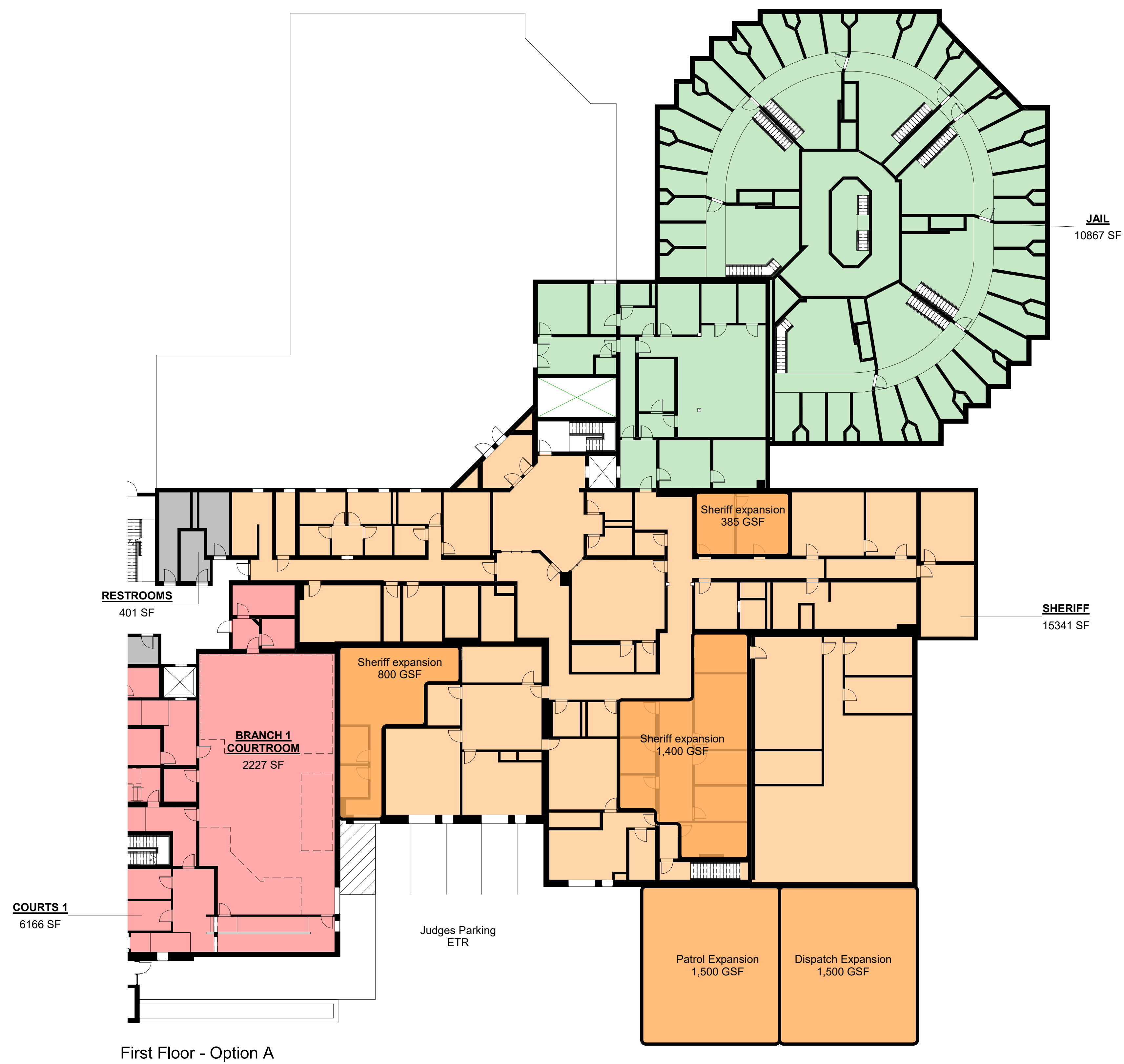

First Floor - Option A

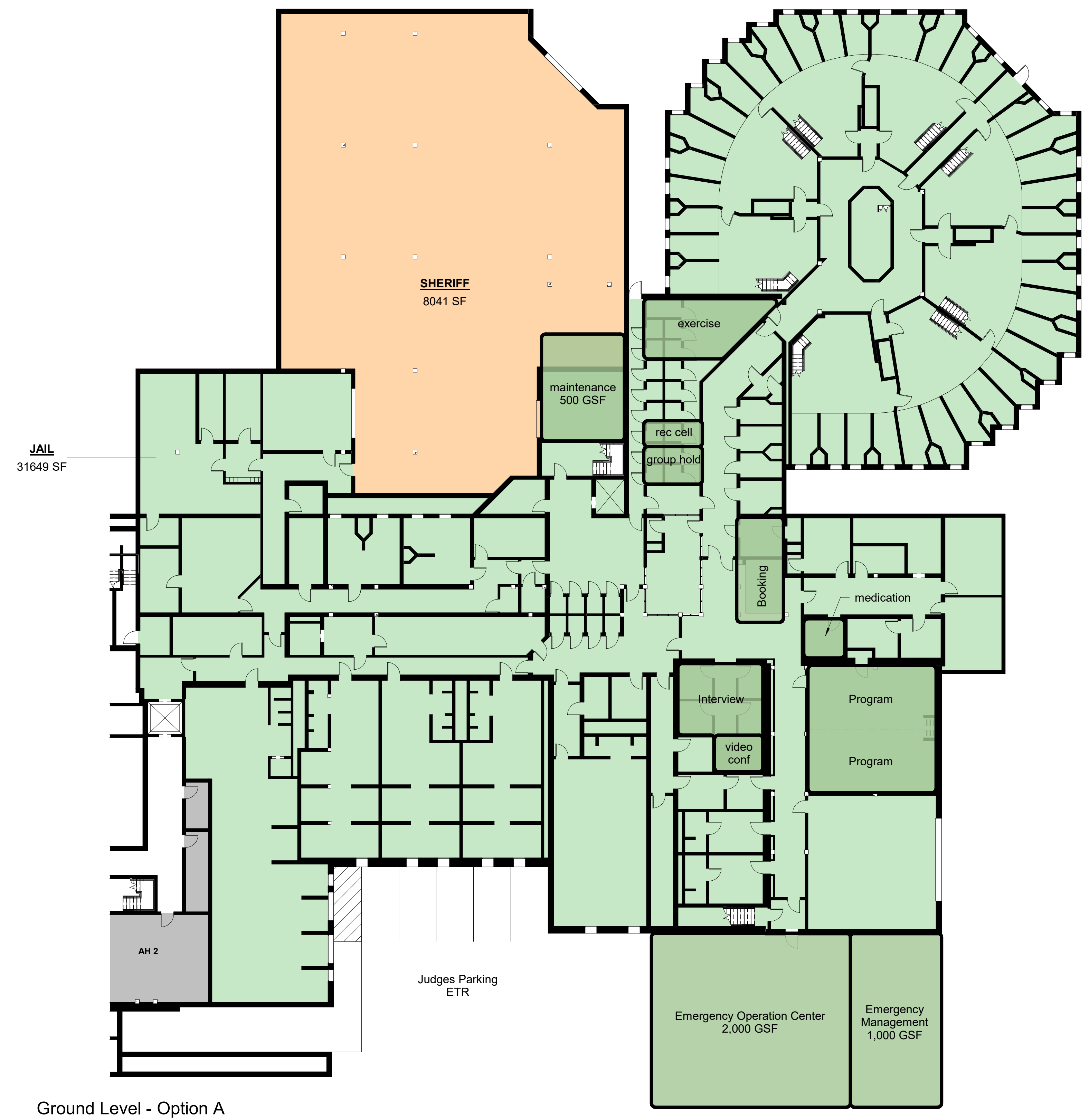

Ground Level - Option A

LEC - Option A

Jefferson County - Preliminary Design Study
03 JUN 2020

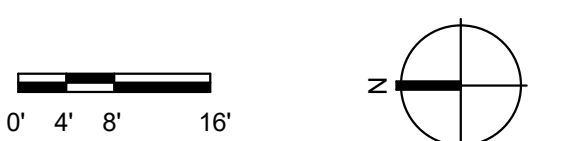

Success by Design

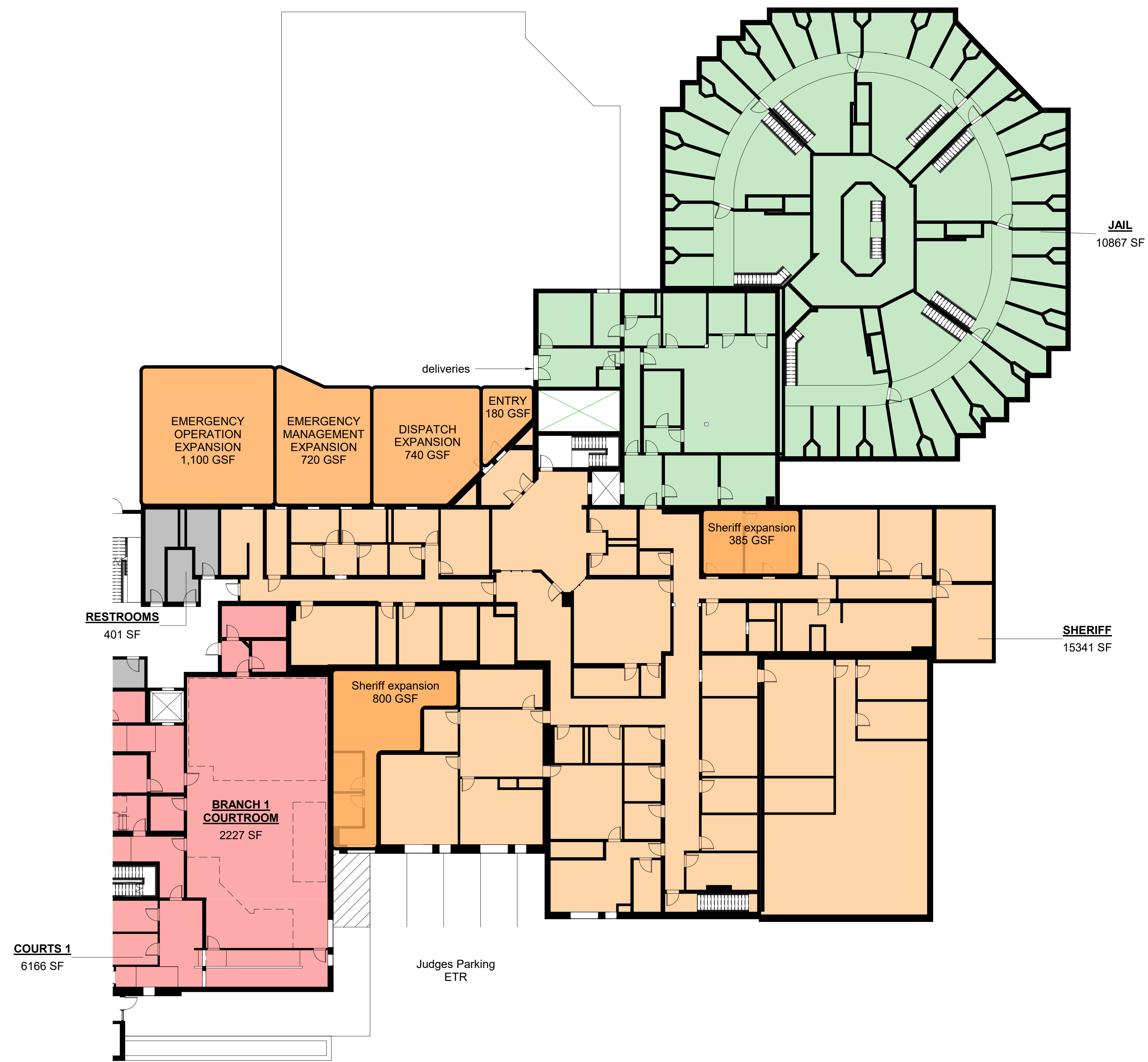

First Floor - Option B

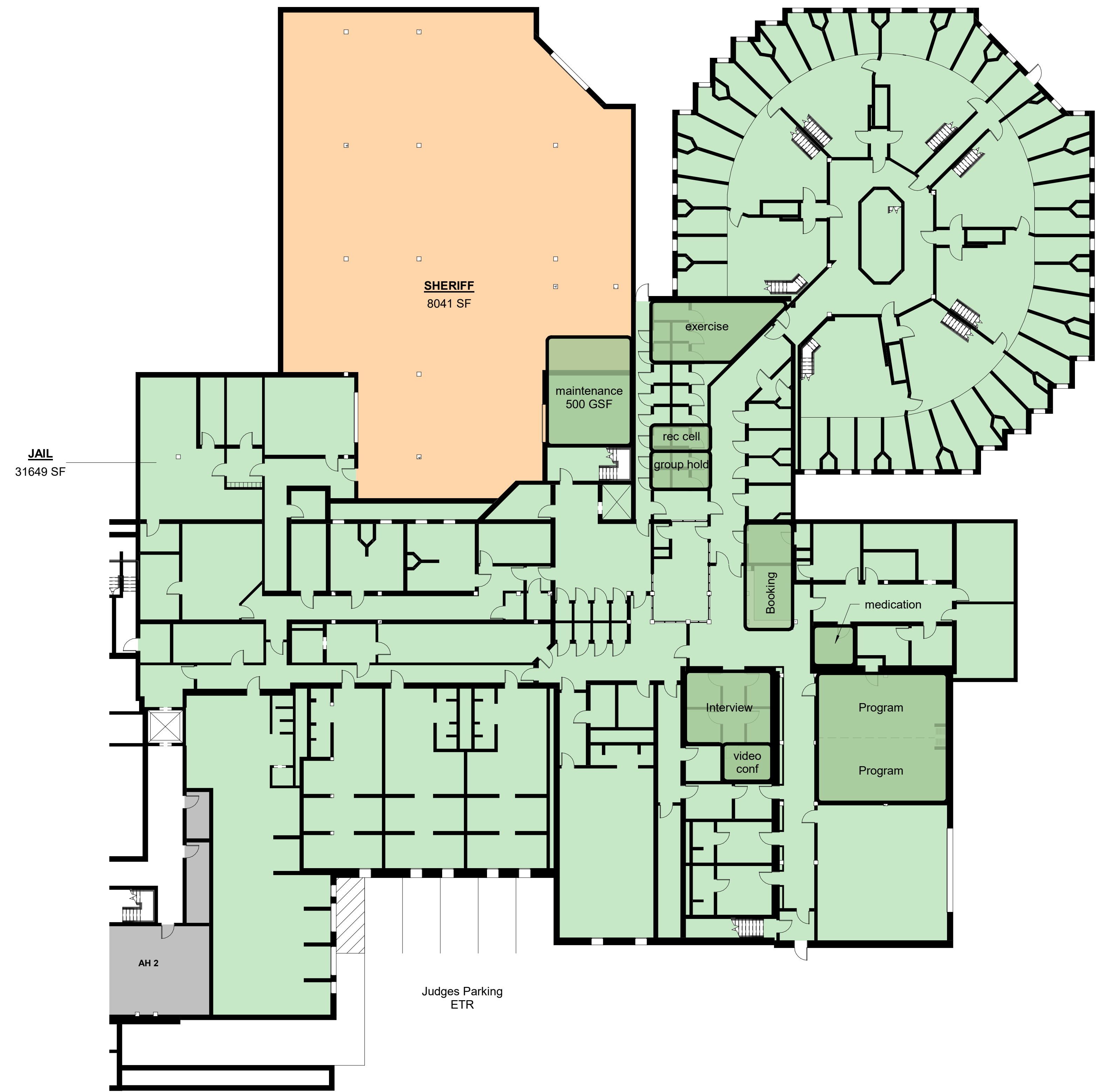

Ground Level - Option B

LEC - Option B

Jefferson County - Preliminary Design Study
03 JUN 2020

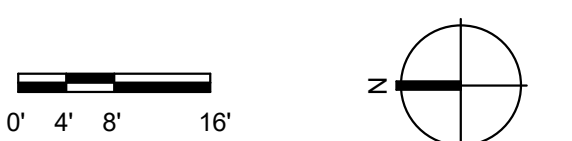

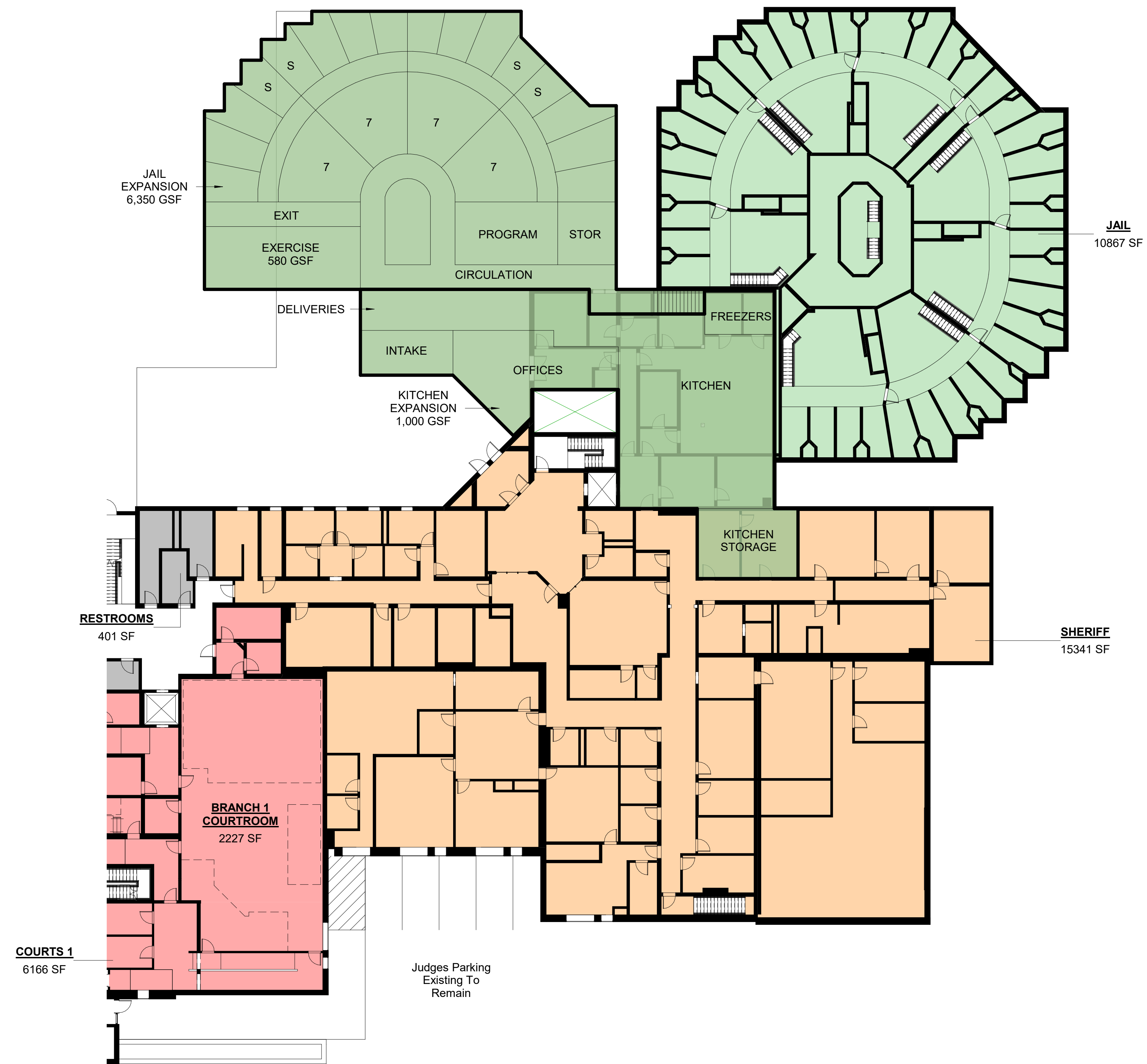

First Floor - Option C

LEC - Option C

Jefferson County - Preliminary Design Study
03 JUN 2020

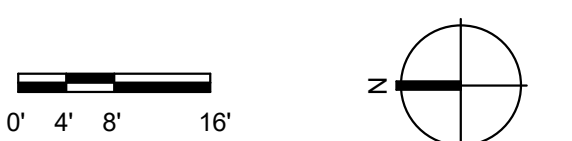

06/22/2020
11:24:53

Jefferson County
CENTRAL SERVICES (YEAR TO DATE)

PAGE 1
glflxrpt

FROM 2020 01 TO 2020 12

	ORIGINAL APPROP	TRANFRS/ ADJSTMTS	REVISED BUDGET	ACTUALS	ENCUMBRANCES	AVAILABLE BUDGET	PCT USED
100 General Fund							
11201 Central Services							
11201 411100 General Property Taxes	-872,789	0	-872,789	-436,394.52	.00	-436,394.48	50.0%
11201 474009 Housekeeping Services	-3,000	0	-3,000	.00	.00	-3,000.00	.0%
11201 483002 Misc Sale/Material & Supply	-500	0	-500	.00	.00	-500.00	.0%
11201 486001 Vending Commission	-500	0	-500	-187.99	.00	-312.01	37.6%
11201 511110 Salary-Permanent Regular	75,220	0	75,220	.00	.00	75,219.82	.0%
11201 511210 Wages-Regular	264,051	0	264,051	107,771.31	.00	156,279.66	40.8%
11201 511210 22101 Wages-Regular	0	0	0	5,936.05	.00	-5,936.05	.0%
11201 511220 Wages-Overtime	4,715	0	4,715	4,345.89	.00	369.05	92.2%
11201 511220 22101 Wages-Overtime	0	0	0	738.50	.00	-738.50	.0%
11201 511330 Wages-Longevity Pay	698	0	698	.00	.00	697.50	.0%
11201 512141 Social Security	25,884	0	25,884	8,367.74	.00	17,516.06	32.3%
11201 512141 22101 Social Security	0	0	0	483.69	.00	-483.69	.0%
11201 512142 Retirement (Employer)	22,346	0	22,346	7,189.59	.00	15,156.65	32.2%
11201 512142 22101 Retirement (Employer)	0	0	0	440.76	.00	-440.76	.0%
11201 512144 Health Insurance	80,222	0	80,222	25,693.65	.00	54,528.17	32.0%
11201 512144 22101 Health Insurance	0	0	0	2,076.18	.00	-2,076.18	.0%
11201 512145 Life Insurance	124	0	124	41.44	.00	82.88	33.3%
11201 512145 22101 Life Insurance	0	0	0	.52	.00	-.52	.0%
11201 512150 FSA Contribution	11,000	0	11,000	.00	.00	11,000.00	.0%
11201 512151 HSA Contribution	0	0	0	9,000.00	.00	-9,000.00	.0%
11201 512173 Dental Insurance	5,964	0	5,964	1,985.64	.00	3,978.36	33.3%
11201 512173 22101 Dental Insurance	0	0	0	155.07	.00	-155.07	.0%
11201 512390 Safety Equipment	200	0	200	.00	.00	200.00	.0%
11201 521215 Architectural & Engineering	5,000	0	5,000	255.75	.00	4,744.25	5.1%
11201 521219 Other Professional Serv	10,000	200,000	210,000	43,699.75	37,100.00	129,200.25	38.5%
11201 521296 Computer Support	100	0	100	.00	.00	100.00	.0%
11201 529170 Grounds Keeping Charges	13,702	0	13,702	3,793.05	.00	9,908.95	27.7%
11201 529299 Purchase Care & Services	5,000	0	5,000	.00	.00	5,000.00	.0%
11201 531008 Hazard Recycle Charges	200	0	200	.00	.00	200.00	.0%
11201 531298 United Parcel Service	500	0	500	379.25	.00	120.75	75.9%
11201 531302 Building & Maint Equipment	5,000	0	5,000	2,702.82	.00	2,297.18	54.1%
11201 531303 Computer Equipmt & Software	12,000	0	12,000	13,461.63	.00	-1,461.63	112.2%
11201 531311 Postage & Box Rent	100	0	100	.00	.00	100.00	.0%
11201 531312 Office Supplies	400	0	400	21.46	.00	378.54	5.4%
11201 531312 22101 Office Supplies	0	0	0	79.00	.00	-79.00	.0%

06/22/2020
11:24:54

Jefferson County
CENTRAL SERVICES (YEAR TO DATE)

FROM 2020 01 TO 2020 12

	ORIGINAL APPROP	TRANFRS/ ADJSTMTS	REVISED BUDGET	ACTUALS	ENCUMBRANCES	AVAILABLE BUDGET	PCT USED
11201 531313 Printing & Duplicating	200	0	200	44.69	.00	155.31	22.3%
11201 531314 Small Items Of Equipment	2,000	0	2,000	1,687.89	.00	312.11	84.4%
11201 531320 Safety Supplies	200	0	200	622.14	.00	-422.14	311.1%
11201 531326 Advertising	1,000	0	1,000	.00	.00	1,000.00	.0%
11201 531351 Gas/Diesel	1,500	0	1,500	190.09	.00	1,309.91	12.7%
11201 532332 Mileage	100	0	100	5.55	.00	94.45	5.6%
11201 533221 Water	5,000	0	5,000	1,401.67	.00	3,598.33	28.0%
11201 533222 Electric	110,000	0	110,000	23,603.24	.00	86,396.76	21.5%
11201 533223 Sewer	5,000	0	5,000	1,422.40	.00	3,577.60	28.4%
11201 533224 Natural Gas	30,000	0	30,000	9,251.03	.00	20,748.97	30.8%
11201 533225 Telephone & Fax	1,000	0	1,000	594.98	.00	405.02	59.5%
11201 533235 Storm Water Utility	2,000	0	2,000	645.00	.00	1,355.00	32.3%
11201 535239 Street Repair & Maint	1,000	0	1,000	.00	.00	1,000.00	.0%
11201 535246 Building Service & Maint	45,000	0	45,000	30,692.87	.68	14,306.45	68.2%
11201 535247 Building Repair & Maint	20,000	0	20,000	3,152.92	.00	16,847.08	15.8%
11201 535247 22101 Building Repair & Maint	0	0	0	.00	86,150.00	-86,150.00	.0%
11201 535297 Refuse Collection	2,500	0	2,500	956.86	.00	1,543.14	38.3%
11201 535344 Household & Janitorial Supp	12,000	0	12,000	8,841.23	.00	3,158.77	73.7%
11201 535344 22101 Household & Janitorial	0	0	0	3,029.40	.00	-3,029.40	.0%
11201 535349 Other Supplies	10,000	0	10,000	8,574.40	.00	1,425.60	85.7%
11201 535352 Vehicle Parts & Repairs	1,500	0	1,500	.00	.00	1,500.00	.0%
11201 535353 Machinery & Equipment Parts	5,000	0	5,000	1,247.19	.00	3,752.81	24.9%
11201 535354 Paint	3,000	0	3,000	2,800.00	905.00	-705.00	123.5%
11201 535355 Plumbing & Electrical	5,000	0	5,000	8,481.25	.00	-3,481.25	169.6%
11201 536531 Land Rent & Lease	1,800	0	1,800	.00	.00	1,800.00	.0%
11201 571004 IP Telephony Allocation	381	0	381	349.25	.00	31.75	91.7%
11201 571007 MIS Direct Charges	500	0	500	.00	.00	500.00	.0%
11201 571009 MIS PC Group Allocation	46,502	0	46,502	42,626.87	.00	3,875.13	91.7%
11201 571010 MIS Systems Grp Alloc(ISIS)	5,098	0	5,098	4,673.13	.00	424.87	91.7%
11201 591519 Other Insurance	17,083	0	17,083	7,117.75	.00	9,964.84	41.7%
11201 594810 Capital Equipment	0	0	0	4,561.00	.00	-4,561.00	.0%
11201 594822 Capital Improvement Building	0	218,820	218,820	143,402.18	.00	75,417.82	65.5%
11201 594822 22101 Capital Improvement Bui	0	0	0	.00	75,615.00	-75,615.00	.0%
11201 699999 Budgetary Fund Balance	0	-418,820	-418,820	.00	.00	-418,820.00	.0%
TOTAL Central Services	0	0	0	112,011.21	199,770.68	-311,781.89	.0%
GRAND TOTAL	0	0	0	112,011.21	199,770.68	-311,781.89	.0%

06/22/2020
11:25:59

Jefferson County
MIS (YEAR TO DATE)

FROM 2020 01 TO 2020 12

	ORIGINAL APPROP	TRANFRS/ ADJSTMTS	REVISED BUDGET	ACTUALS	ENCUMBRANCES	AVAILABLE BUDGET	PCT USED
700 MIS Department Fund							
77001 PC Group							
77001 474180 MIS Billed	-883,542	0	-883,542	-845,872.72	.00	-37,669.51	95.7%
77001 511110 Salary-Permanent Regular	74,880	0	74,880	.00	.00	74,879.79	.0%
77001 511210 Wages-Regular	128,020	0	128,020	83,258.87	.00	44,760.79	65.0%
77001 511220 Wages-Overtime	612	0	612	355.75	.00	256.16	58.1%
77001 511330 Wages-Longevity Pay	294	0	294	.00	.00	293.75	.0%
77001 512141 Social Security	14,826	0	14,826	6,181.92	.00	8,644.17	41.7%
77001 512142 Retirement (Employer)	12,694	0	12,694	5,643.87	.00	7,050.36	44.5%
77001 512144 Health Insurance	38,568	0	38,568	15,868.46	.00	22,699.70	41.1%
77001 512145 Life Insurance	44	0	44	24.29	.00	19.57	55.4%
77001 512151 HSA Contribution	5,000	0	5,000	5,000.00	.00	.00	100.0%
77001 512173 Dental Insurance	3,204	0	3,204	1,410.13	.00	1,793.87	44.0%
77001 521220 Consultant	127,500	0	127,500	32,666.90	.00	94,833.10	25.6%
77001 521296 Computer Support	260,315	0	260,315	203,946.52	.00	56,368.15	78.3%
77001 529299 Purchase Care & Services	0	0	0	2,122.00	.00	-2,122.00	.0%
77001 531243 Furniture & Furnishings	500	0	500	.00	.00	500.00	.0%
77001 531298 United Parcel Service	0	0	0	23.17	.00	-23.17	.0%
77001 531301 Office Equipment	300	0	300	.00	.00	300.00	.0%
77001 531303 Computer Equipmt & Software	32,000	0	32,000	10,776.19	7,341.00	13,882.81	56.6%
77001 531303 22101 Computer Equipmt & Soft	0	0	0	7,109.50	.00	-7,109.50	.0%
77001 531307 Microsoft Office Upgrade	71,000	0	71,000	70,844.00	.00	156.00	99.8%
77001 531312 Office Supplies	3,500	0	3,500	.00	.00	3,500.00	.0%
77001 531313 Printing & Duplicating	100	0	100	.00	.00	100.00	.0%
77001 531314 Small Item Of Equipment	300	0	300	.00	.00	300.00	.0%
77001 531322 Subscriptions	330	0	330	.00	.00	330.00	.0%
77001 531324 Membership Dues	500	0	500	.00	.00	500.00	.0%
77001 532325 Registration	1,000	0	1,000	50.00	.00	950.00	5.0%
77001 532332 Mileage	200	0	200	13.82	.00	186.18	6.9%
77001 532335 Meals	100	0	100	.00	.00	100.00	.0%
77001 532336 Lodging	200	0	200	.00	.00	200.00	.0%
77001 532350 Training Materials	2,500	0	2,500	2,130.00	.00	370.00	85.2%
77001 533228 Internet	27,700	0	27,700	11,316.00	.00	16,384.00	40.9%
77001 535242 Maintain Machinery & Equip	15,000	0	15,000	32,467.39	.00	-17,467.39	216.4%
77001 535355 Plumbing & Electrical	1,000	0	1,000	.00	.00	1,000.00	.0%
77001 571004 IP Telephony Allocation	3,559	0	3,559	3,262.38	.00	296.62	91.7%
77001 571008 MIS Overhead Allocation	16,351	0	16,351	.00	.00	16,350.72	.0%

06/22/2020
11:25:59

Jefferson County
MIS (YEAR TO DATE)

FROM 2020 01 TO 2020 12

	ORIGINAL APPROP	TRANFRS/ ADJSTMTS	REVISED BUDGET	ACTUALS	ENCUMBRANCES	AVAILABLE BUDGET	PCT USED
77001 591519 Other Insurance	1,446	0	1,446	602.65	.00	843.74	41.7%
77001 594810 Capital Equipment	122,000	58,000	180,000	105,310.93	16,942.00	57,747.07	67.9%
77001 611102 Transfer From General	-82,000	0	-82,000	.00	.00	-82,000.00	.0%
77001 699999 Budgetary Fund Balance	0	-58,000	-58,000	.00	.00	-58,000.00	.0%
TOTAL PC Group	0	0	0	-245,487.98	24,283.00	221,204.98	.0%

06/22/2020
11:25:59

Jefferson County
MIS (YEAR TO DATE)

FROM 2020 01 TO 2020 12

	ORIGINAL APPROP	TRANFRS/ ADJSTMTS	REVISED BUDGET	ACTUALS	ENCUMBRANCES	AVAILABLE BUDGET	PCT USED
<hr/>							
77002 Systems Group							
77002 451200 Records & Reports	0	0	0	-175.00	.00	175.00	.0%
77002 474180 MIS Billed	-393,370	0	-393,370	-360,588.25	.00	-32,781.98	91.7%
77002 511110 Salary-Permanent Regular	196,717	0	196,717	84,215.35	.00	112,501.63	42.8%
77002 511210 Wages-Regular	30,884	0	30,884	15,437.83	.00	15,446.19	50.0%
77002 511330 Wages-Longevity Pay	583	0	583	.00	.00	582.50	.0%
77002 512141 Social Security	17,464	0	17,464	7,314.89	.00	10,149.56	41.9%
77002 512142 Retirement (Employer)	14,953	0	14,953	6,726.59	.00	8,226.63	45.0%
77002 512144 Health Insurance	40,175	0	40,175	16,805.09	.00	23,370.03	41.8%
77002 512145 Life Insurance	138	0	138	68.48	.00	69.94	49.5%
77002 512151 HSA Contribution	5,000	0	5,000	8,000.00	.00	-3,000.00	160.0%
77002 512173 Dental Insurance	2,700	0	2,700	1,255.12	.00	1,444.88	46.5%
77002 521220 Consultant	3,000	0	3,000	2,950.00	.00	50.00	98.3%
77002 521296 Computer Support	4,000	0	4,000	3,001.67	.00	998.33	75.0%
77002 531303 Computer Equipmt & Software	6,500	0	6,500	.00	.00	6,500.00	.0%
77002 531312 Office Supplies	500	0	500	599.00	.00	-99.00	119.8%
77002 531322 Subscriptions	125	0	125	.00	.00	125.00	.0%
77002 531324 Membership Dues	300	0	300	.00	.00	300.00	.0%
77002 532325 Registration	3,400	0	3,400	.00	.00	3,400.00	.0%
77002 532332 Mileage	100	0	100	.00	.00	100.00	.0%
77002 532334 Commercial Travel	450	0	450	.00	.00	450.00	.0%
77002 532335 Meals	120	0	120	.00	.00	120.00	.0%
77002 532336 Lodging	1,500	0	1,500	.00	.00	1,500.00	.0%
77002 532339 Other Travel & Tolls	150	0	150	.00	.00	150.00	.0%
77002 532350 Training Materials	1,000	0	1,000	.00	.00	1,000.00	.0%
77002 535242 Maintain Machinery & Equip	44,240	0	44,240	33,755.54	.00	10,484.46	76.3%
77002 571004 IP Telephony Allocation	636	0	636	583.00	.00	53.00	91.7%
77002 571008 MIS Overhead Allocation	16,351	0	16,351	.00	.00	16,350.72	.0%
77002 591519 Other Insurance	2,384	0	2,384	993.25	.00	1,390.55	41.7%
TOTAL Systems Group	0	0	0	-179,057.44	.00	179,057.44	.0%

06/22/2020
11:25:59

Jefferson County
MIS (YEAR TO DATE)

PAGE 4
glflxrpt

FROM 2020 01 TO 2020 12

	ORIGINAL APPROP	TRANFRS/ ADJSTMTS	REVISED BUDGET	ACTUALS	ENCUMBRANCES	AVAILABLE BUDGET	PCT USED
<hr/>							
77003 Programming - Special							
77003 474099 Dept Cap Program Charges	-133,708	0	-133,708	-122,565.96	.00	-11,142.35	91.7%
77003 511210 Wages-Regular	91,919	0	91,919	37,178.98	.00	54,740.27	40.4%
77003 512141 Social Security	7,032	0	7,032	2,697.25	.00	4,334.57	38.4%
77003 512142 Retirement (Employer)	6,021	0	6,021	2,509.57	.00	3,511.14	41.7%
77003 512144 Health Insurance	24,105	0	24,105	9,642.31	.00	14,462.76	40.0%
77003 512145 Life Insurance	11	0	11	4.89	.00	6.57	42.7%
77003 512151 HSA Contribution	3,000	0	3,000	.00	.00	3,000.00	.0%
77003 512173 Dental Insurance	1,620	0	1,620	690.00	.00	930.00	42.6%
TOTAL Programming - Special	0	0	0	-69,842.96	.00	69,842.96	.0%

06/22/2020
11:25:59

Jefferson County
MIS (YEAR TO DATE)

PAGE 5
glflxrpt

FROM 2020 01 TO 2020 12

	ORIGINAL APPROP	TRANFRS/ ADJSTMTS	REVISED BUDGET	ACTUALS	ENCUMBRANCES	AVAILABLE BUDGET	PCT USED
<hr/>							
77004 MIS Overhead							
77004 521296 Computer Support	0	0	0	8,142.96	.00	-8,142.96	.0%
77004 529299 Purchase Care & Services	4,500	0	4,500	126.80	.00	4,373.20	2.8%
77004 531298 United Parcel Service	200	0	200	.00	.00	200.00	.0%
77004 531320 Safety Supplies	50	0	50	238.50	.00	-188.50	477.0%
77004 533221 Water	400	0	400	180.89	.00	219.11	45.2%
77004 533222 Electric	6,250	0	6,250	1,091.99	.00	5,158.01	17.5%
77004 533223 Sewer	319	0	319	164.40	.00	154.60	51.5%
77004 533224 Natural Gas	2,500	0	2,500	771.93	.00	1,728.07	30.9%
77004 533225 Telephone & Fax	3,400	0	3,400	2,069.75	.00	1,330.25	60.9%
77004 533235 Storm Water Utility	180	0	180	59.96	.00	120.04	33.3%
77004 533236 Wireless Internet	3,200	0	3,200	523.00	.00	2,677.00	16.3%
77004 533236 22101 Wireless Internet	0	0	0	3,186.82	.00	-3,186.82	.0%
77004 535242 Maintain Machinery & Equip	6,500	0	6,500	.00	.00	6,500.00	.0%
77004 535246 Building Service & Maint	2,000	0	2,000	.00	.00	2,000.00	.0%
77004 535297 Refuse Collection	550	0	550	241.95	.00	308.05	44.0%
77004 571003 Housekeeping	2,200	0	2,200	.00	.00	2,200.00	.0%
77004 571008 MIS Overhead Allocation	-32,701	0	-32,701	.00	.00	-32,701.44	.0%
77004 591519 Other Insurance	452	0	452	188.50	.00	263.94	41.7%
TOTAL MIS Overhead	0	0	0	16,987.45	.00	-16,987.45	.0%

06/22/2020
11:25:59

Jefferson County
MIS (YEAR TO DATE)

FROM 2020 01 TO 2020 12

	ORIGINAL APPROP	TRANFRS/ ADJSTMTS	REVISED BUDGET	ACTUALS	ENCUMBRANCES	AVAILABLE BUDGET	PCT USED
<hr/>							
77005 IP-Telephony							
77005 474190 IP-Telephony Billed	-95,452	0	-95,452	-87,498.84	.00	-7,953.41	91.7%
77005 511210 Wages-Regular	28,546	0	28,546	11,645.08	.00	16,900.84	40.8%
77005 511220 Wages-Overtime	0	0	0	12.13	.00	-12.13	.0%
77005 512141 Social Security	2,184	0	2,184	891.76	.00	1,292.00	40.8%
77005 512142 Retirement (Employer)	1,870	0	1,870	786.88	.00	1,083.09	42.1%
77005 512145 Life Insurance	14	0	14	5.65	.00	8.33	40.4%
77005 512173 Dental Insurance	540	0	540	276.00	.00	264.00	51.1%
77005 521220 Consultant	5,500	0	5,500	3,972.28	.00	1,527.72	72.2%
77005 521296 Computer Support	30,582	0	30,582	23,434.60	.00	7,147.27	76.6%
77005 531303 Computer Equipmt & Software	23,000	0	23,000	.00	.00	23,000.00	.0%
77005 535242 Maintain Machinery & Equip	3,000	0	3,000	.00	.00	3,000.00	.0%
77005 591519 Other Insurance	217	0	217	90.30	.00	126.45	41.7%
TOTAL IP-Telephony	0	0	0	-46,384.16	.00	46,384.16	.0%

06/22/2020
11:25:59

Jefferson County
MIS (YEAR TO DATE)

PAGE 7
gflxrpt

FROM 2020 01 TO 2020 12

	ORIGINAL APPROP	TRANFRS/ ADJSTMTS	REVISED BUDGET	ACTUALS	ENCUMBRANCES	AVAILABLE BUDGET	PCT USED
<hr/>							
77006 Central Duplication							
77006 451002 Private Party Photocopy	-1,400	0	-1,400	-288.54	.00	-1,111.46	20.6%
77006 472003 Municipality Copies & Printin	-550	0	-550	-602.50	.00	52.50	109.5%
77006 474180 MIS Billed	-16,496	0	-16,496	-15,140.62	.00	-1,355.74	91.8%
77006 474200 Copying & Printing Interdepa	-36,000	0	-36,000	-17,476.37	.00	-18,523.63	48.5%
77006 511210 Wages-Regular	18,410	0	18,410	9,514.97	.00	8,894.60	51.7%
77006 511210 22101 Wages-Regular	0	0	0	656.82	.00	-656.82	.0%
77006 511330 Wages-Longevity Pay	59	0	59	.00	.00	59.40	.0%
77006 512141 Social Security	1,413	0	1,413	727.88	.00	685.00	51.5%
77006 512141 22101 Social Security	0	0	0	50.24	.00	-50.24	.0%
77006 512142 Retirement (Employer)	1,210	0	1,210	642.27	.00	567.45	53.1%
77006 512142 22101 Retirement (Employer)	0	0	0	44.33	.00	-44.33	.0%
77006 512145 Life Insurance	9	0	9	2.82	.00	5.82	32.6%
77006 512145 22101 Life Insurance	0	0	0	.20	.00	-.20	.0%
77006 512173 Dental Insurance	1,080	0	1,080	.00	.00	1,080.00	.0%
77006 531311 Postage & Box Rent	0	0	0	3.38	.00	-3.38	.0%
77006 531312 Office Supplies	9,500	0	9,500	6,975.99	.00	2,524.01	73.4%
77006 531314 Small Items Of Equipment	500	0	500	.00	.00	500.00	.0%
77006 531349 Other Operating Expenses	350	0	350	.00	.00	350.00	.0%
77006 532332 Mileage	40	0	40	.00	.00	40.00	.0%
77006 533225 Telephone & Fax	90	0	90	7.73	.00	82.27	8.6%
77006 535242 Maintain Machinery & Equip	4,000	0	4,000	963.68	.00	3,036.32	24.1%
77006 535252 Printing Equip Maintenance	14,000	0	14,000	3,706.48	.00	10,293.52	26.5%
77006 571004 IP Telephony Allocation	127	0	127	116.38	.00	10.62	91.6%
77006 571009 MIS PC Group Allocation	3,171	0	3,171	2,906.75	.00	264.25	91.7%
77006 571010 MIS Systems Grp Alloc(ISIS)	347	0	347	318.12	.00	28.88	91.7%
77006 591519 Other Insurance	141	0	141	58.80	.00	82.35	41.7%
TOTAL Central Duplication	0	0	0	-6,811.19	.00	6,811.19	.0%
GRAND TOTAL	0	0	0	-530,596.28	24,283.00	506,313.28	.0%